







**LEGENDE:**

-  Doortrit (vlak)
-  Hellingen
-  Parkeerplaats
-  Garage
-  Berging
-  Fietsenstalling

**Res. ARTEVELDE  
KELDER -2**

projectontwikkeling:

**Willemien Real Estate**  
Boerenkrijgstraat 133  
2800 Mechelen

Architect:  
**b.v.b.a. PLATO**  
Leopold PATTYN Arch.-Sted.  
Zeeweg Zuid 3  
8211 Aartrijke

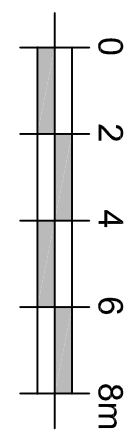
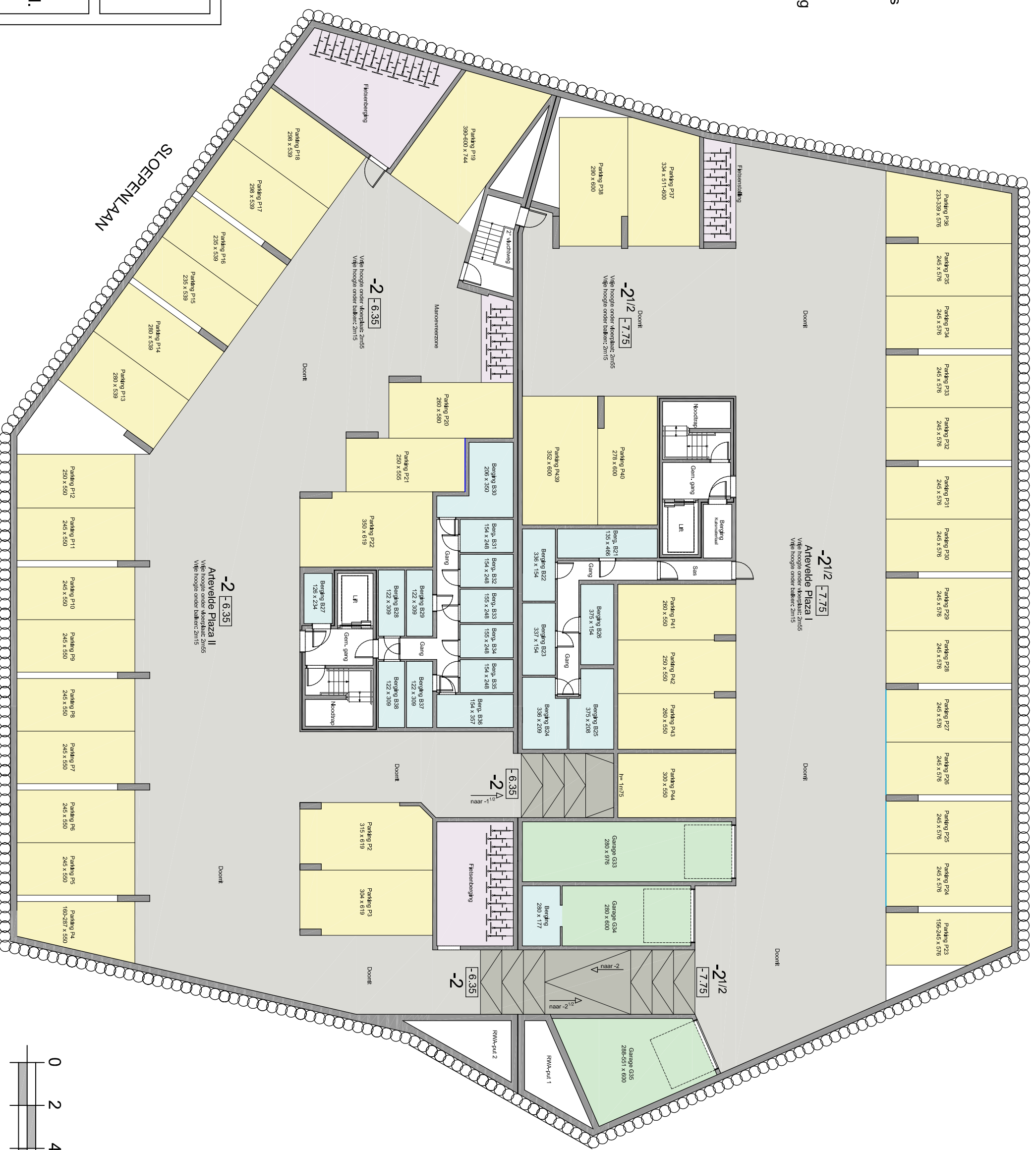

Alle vermelde afmetingen zijn ten titel van inlichting en derhalve niet absoluut bindend